

PROJECT NO.	SHEET NO.	TOTAL NO.
2021CPT.11.21.20032	1	2
2021CPT.11.21.20862		
2021CPT.11.21.20972		
2021CPT.11.21.20992		

## SUMMARY OF QUANTITIES

PROJECT NO.	COUNTY	MAP NO.	ROUTE	ROUTE NAME	FROM DESCRIPTION	TO DESCRIPTION	MILE POST FROM	MILE POST TO	TYP NO.	LANES	LANE TYPE	LENGTH	WIDTH	1803500000-E	1820000000-E	1836000000-E	1838000000-E	1838500000-N	2143000000-E	4413000000-E	4457000000-N		
														ASPHALT SURFACE TREATMENT, DOUBLE SEAL	ASPHALT SURFACE TREATMENT, FOG SEAL	ASPHALT SURFACE TREATMENT, TRIPLE SEAL	EMULSION FOR ASPHALT SURFACE TREATMENT	VACUUM TRUCK	BLOTTING SAND	WORK ZONE ADVANCE/GENERAL WARNING SIGNING	TEMPORARY TRAFFIC CONTROL		
													MI	FT	SY	SY	SY	GAL	WK	TON	SF	LS	
2021CPT.11.21.20032	Allegheny	1	SR 1211	River Creek Dr	SR 1128	END Maintenance	0.00	0.14	2	2	2WU	0.14	18	1,478	1,478			991	5	500	18	1	
2021CPT.11.21.20032	Allegheny	2	SR 1212	Dockery Ln	SR 1211	END Maintenance	0.00	0.20	2	2	2WU	0.20	18	2,080	2,080			1,394			26		
2021CPT.11.21.20032	Allegheny	3	SR 1310	Deacon Rd	VA LINE	EOP/SR 1311	0.00	1.05	2	2	2WU	1.05	18	11,088	11,088						137		
2021CPT.11.21.20032	Allegheny	4	SR 1312	Double Branch Rd	SR 1310	ASHE CO LINE	0.00	0.44	2	2	2WU	0.44	18	4,646	4,646						57		
2021CPT.11.21.20032	Allegheny	5	SR 1341	Osborne Memorial Rd	NC 93	SR 1317	0.00	1.10	2	2	2WU	1.10	18	11,616	11,616						143		
2021CPT.11.21.20032	Allegheny	6	SR 1421	Rivers Edge Rd	US 21	END Maintenance	0.00	1.21	2	2	2WU	1.21	18	12,778	12,778						157		
2021CPT.11.21.20032	Allegheny	7	SR 1433	Scenic Valley Rd	BRP	SR 1464	0.00	0.58	2	2	2WU	0.58	18	6,125	6,125						75		
2021CPT.11.21.20032	Allegheny	8	SR 1433	Scenic Valley Rd	SR 1464	SR 1444	0.58	2.91	2	2	2WU	2.33	20	27,339	27,339						303		
2021CPT.11.21.20032	Allegheny	9	SR 1433	Ridgeglen Rd	SR 1422	NC 18	3.94	7.35	2	2	2WU	3.41	18	36,010	36,010						443		
2021CPT.11.21.20032	Allegheny	10	SR 1456	Presnell Rd	SR 1433	CDS	0.00	0.50	2	2	2WU	0.50	19	5,573	5,573						65		
<b>TOTAL FOR PROJECT NO. 2021CPT.11.21.20032</b>													<b>10.96</b>		<b>118,733</b>	<b>118,733</b>	<b>0</b>	<b>79,551</b>	<b>5</b>	<b>500</b>	<b>1,424</b>	<b>1</b>	

2021CPT.11.21.20862	Surry	11	SR 1158	Martin Byrd Rd	WILKES CO LINE/SR 2043	SR 1157	0.00	0.26	1	2	2WU	0.26	18			2,746	2,169				34	
2021CPT.11.21.20862	Surry	12	SR 1301	Mountain Park Rd	SR 1315	SR 1322	5.27	5.93	1	2	2WU	0.66	16			6,195	4,894				86	
2021CPT.11.21.20862	Surry	13	SR 1347	Old County Home Rd	SR 1345	EOM	0.00	1.40	1	2	2WU	1.40	20			16,427	0				182	
2021CPT.11.21.20862	Surry	14	SR 1524	Meadowview Dr	SR 1357	END MAINT	0.00	0.20	2	2	2WU	0.20	20	2,347	2,347						26	
2021CPT.11.21.20862	Surry	15	SR 1533	Betty Ave	SR 1350	CUL-DE-SAC	0.00	0.12	2	2	2WU	0.12	20	1,385	1,385						15	
2021CPT.11.21.20862	Surry	16	SR 1552	Brush Arbor Ln	SR 1350	CUL-DE-SAC	0.00	0.19	2	2	2WU	0.19	20	2,276	2,276						25	
2021CPT.11.21.20862	Surry	17	SR 1666	Norval Lowe Rd	NC 89	EOM	0.00	0.20	2	2	2WU	0.20	20	2,347	2,347						26	
2021CPT.11.21.20862	Surry	18	SR 1702	Parker Rd	SR 1701	Virginia State Line	0.00	1.31	1	2	2WU	1.31	20			15,371	12,143				170	
2021CPT.11.21.20862	Surry	19	SR 1720	Dusty Ln	SR 1717	CUL-DE-SAC	0.00	0.30	2	2	2WU	0.30	16	2,816	2,816						39	
2021CPT.11.21.20862	Surry	20	SR 1731	Bottom Rd	SR 1732	NC 103	0.00	0.16	2	2	2WU	0.16	20	1,877	1,877						21	
2021CPT.11.21.20862	Surry	21	SR 1732	Old E. Pine St *	NC 103	NC 103	0.00	0.38	2	2	2WU	0.38	20	4,459	4,459						49	
2021CPT.11.21.20862	Surry	22	SR 1733	Burton St	SR 1732	SR 1732	0.00	0.33	2	2	2WU	0.33	20	3,872	3,872						43	
2021CPT.11.21.20862	Surry	23	SR 1739	Monroe Rd	SR 1727	SR 1740	0.00	0.42	2	2	2WU	0.42	16	3,942	3,942						55	
2021CPT.11.21.20862	Surry	24	SR 1754	Hilda Rd/Lynn Rd	SR 1753	END MNTC	0.00	0.29	2	2	2WU	0.29	16	2,722	2,722						38	
2021CPT.11.21.20862	Surry	25	SR 1755	Cox Dr	NC 89	SR 1754	0.00	0.19	2	2	2WU	0.19	20	2,229	2,229						25	
2021CPT.11.21.20862	Surry	26	SR 1756	Midway St/Welcome Bapt Ch Rd	NC 89	SR 1759	0.00	0.75	2	2	2WU	0.75	20	8,800	8,800						98	
2021CPT.11.21.20862	Surry	27	SR 1756	Hamburg St	SR 1759	SR 1753	0.75	1.23	2	2	2WU	0.48	18	5,069	5,069						62	
2021CPT.11.21.20862	Surry	28	SR 1757	Midway St	SR 1756	EOM	0.00	0.10	2	2	2WU	0.10	18	1,056	1,056						13	
2021CPT.11.21.20862	Surry	29	SR 1765	Fairview Dr	NC 89	END MNTC	0.00	0.30	2	2	2WU	0.30	16	2,816	2,816						39	
2021CPT.11.21.20862	Surry	30	SR 1772	Old Buck Shoals Rd	US 52	EOM	0.58	1.41	2	2	2WU	0.83	20	9,739	9,739						108	
2021CPT.11.21.20862	Surry	31	SR 1787	Slate Mountain Rd	SR 1788	NC 89	1.88	2.92	1	2	2WU	1.04	18			10,982	8,676				135	
2021CPT.11.21.20862	Surry	32	SR 1789	Albion Ch Rd	SR 1798	STOKES CO LINE	4.56	5.10	1	2	2WU	0.54	20			6,359	5,024				70	
2021CPT.11.21.20862	Surry	33	SR 1811	Cleo Cain Rd/Toms Crk Ch Rd	SR 1812	SR 1809	0.00	3.48	1	2	2WU	3.48	19			38,790	30,644				452	
2021CPT.11.21.20862	Surry	34	SR 1812	Jessup Grove Ch Rd	STOKES	SR 1809	0.00	1.56	1	2	2WU	1.56	20			18,304	14,460				203	
2021CPT.11.21.20862	Surry	35	SR 1816	Jim Hill Rd	SR 1815	CUL-DE-SAC	0.00	0.63	1	2	2WU	0.63	18			6,653	5,256				82	
2021CPT.11.21.20862	Surry	36	SR 1820	Russell Ln	SR 1774	SR 1877	0.00	0.41	2	2	2WU	0.41	18	4,330	4,330						53	
2021CPT.11.21.20862	Surry	37	SR 1829	Needham Rd	SR 1815	EOM	0.00	0.67	1	2	2WU	0.67	18			7,075	5,589				87	
2021CPT.11.21.20862	Surry	38	SR 1872	Hunter Rd	NC 89	EOM	0.00	0.24	2	2	2WU	0.24	20	2,839	2,839						31	
2021CPT.11.21.20862	Surry	39	SR 1874	Bateman Rd	SR 1738	EOM	0.00	0.17	2	2	2WU	0.17	16	1,596	1,596						22	
2021CPT.11.21.20862	Surry	40	SR 1877	Russell Rd	SR 1820	SR 1774	0.00	0.40	2	2	2WU	0.40	20	4,693	4,693						52	
2021CPT.11.21.20862	Surry	41	SR 1878	Arnder Rd	SR 1774	SR 1822	0.00	0.86	2	2	2WU	0.86	20	10,091	10,091						112	
2021CPT.11.21.20862	Surry	42	SR 1889	Hilda Dr	SR 1872	SR 1754	0.00	0.18	2	2	2WU	0.18	18	1,901	1,901						23	
2021CPT.11.21.20862	Surry	43	SR 1894	Janice Dr	SR 1815	CUL-DE-DAC	0.01	0.41	2	2	2WU	0.40	26	6,101	6,101						52	
2021CPT.11.21.20862	Surry	44	SR 1895	Gilda Dr	SR 1894	SR 1900	0.00	0.38	2	2	2WU	0.38	20	4,459	4,459						49	
2021CPT.11.21.20862	Surry	45	SR 1900	Holly Ave/Daniel Ln	SR 1960	END MAINT	0.00	0.54	2	2	2WU	0.54	26	8,237	8,237						70	

PROJECT NO.	SHEET NO.	TOTAL NO.
2021CPT.11.21.20032	2	2
2021CPT.11.21.20862		
2021CPT.11.21.20972		
2021CPT.11.21.20992		

### SUMMARY OF QUANTITIES

PROJECT NO.	COUNTY	MAP NO.	ROUTE	ROUTE NAME	FROM DESCRIPTION	TO DESCRIPTION	MILE POST FROM	MILE POST TO	TYP NO.	LANES	LANE TYPE	LENGTH	WIDTH	1803500000-E	1820000000-E	1836000000-E	1838000000-E	1838500000-N	2143000000-E	4413000000-E	4457000000-N	
														ASPHALT SURFACE TREATMENT, DOUBLE SEAL	ASPHALT SURFACE TREATMENT, FOG SEAL	ASPHALT SURFACE TREATMENT, TRIPLE SEAL	EMULSION FOR ASPHALT SURFACE TREATMENT	VACUUM TRUCK	BLOTTING SAND	WORK ZONE ADVANCE/GENERAL WARNING SIGNING	TEMPORARY TRAFFIC CONTROL	
														SY	SY	SY	GAL	WK	TON	SF	LS	
2021CPT.11.21.20862	Surry	46	SR 1901	Key St	SR 1815	EOM	0.00	0.18	2	2	2WU	0.18	20	2,112	2,112		1,415				23	
2021CPT.11.21.20862	Surry	47	SR 1913	Buena Vista Dr	SR 1815	CUL-DE-SAC	0.00	0.60	2	2	2WU	0.60	20	7,040	7,040		4,717				78	
2021CPT.11.21.20862	Surry	48	SR 1914	Brenda Dr	NC 89	SR 1915	0.00	0.18	2	2	2WU	0.18	20	2,112	2,112		1,415				23	
2021CPT.11.21.20862	Surry	48A	SR 1915	McGee Street	SR 1914	EOM	0.00	0.13	2	2	2WU	0.13	18	1,373	1,373		920				17	
2021CPT.11.21.20862	Surry	49	SR 1916	Town Ln	SR 1915	END MNTC	0.00	0.13	2	2	2WU	0.13	20	1,525	1,525		1,022				17	
2021CPT.11.21.20862	Surry	50	SR 1948	Southridge Dr	SR 1774	CUL-DE-SAC	0.00	0.45	2	2	2WU	0.45	20	5,280	5,280		3,538				59	
2021CPT.11.21.20862	Surry	51	SR 1949	Southridge Ln	SR 1948	SR 1950	0.00	0.10	2	2	2WU	0.10	20	1,173	1,173		786				13	
2021CPT.11.21.20862	Surry	52	SR 1950	Southridge Pl	CUL-DE-SAC	CUL-DE-SAC	0.00	0.25	2	2	2WU	0.25	20	2,933	2,933		1,965				33	
2021CPT.11.21.20862	Surry	53	SR 1956	Huntington Ct	SR 1913	CUL-DE-SAC	0.00	0.18	2	2	2WU	0.18	18	1,901	1,901		1,274				23	
2021CPT.11.21.20862	Surry	54	SR 2010	Eaton Rd	SR 1772	CUL-DE-SAC	0.00	0.18	2	2	2WU	0.18	16	1,708	1,708		1,145				24	
2021CPT.11.21.20862	Surry	55	SR 2031	Key Rd	SR 2029	SR 2019	0.00	1.38	1	2	2WU	1.38	18			14,573	11,513				179	
2021CPT.11.21.20862	Surry	56	SR 2055	Pinnacle View Ch Rd	SR 2048	EOM	0.00	0.31	1	2	2WU	0.31	16			2,910	2,299				40	
2021CPT.11.21.20862	Surry	57	SR 2067	Grassy Creek Rd	BR# 142	SR 2048	1.64	3.02	1	2	2WU	1.38	18			14,573	11,513				179	
2021CPT.11.21.20862	Surry	58	SR 2089	Shinault Rd	SR 2047	CUL-DE-SAC	0.00	0.40	2	2	2WU	0.40	16	3,755	3,755		2,516				52	
2021CPT.11.21.20862	Surry	59	SR 2108	Lineback Rd	SR 1772	EOM	0.00	0.19	2	2	2WU	0.19	16	1,783	1,783		1,195				25	
2021CPT.11.21.20862	Surry	60	SR 2166	Honey Branch Ln	SR 2026	EOM	0.00	0.32	1	2	2WU	0.32	18			3,379	2,670				42	
2021CPT.11.21.20862	Surry	61	SR 2201	Dover Ch Rd	SR 2200	SR 2243	0.00	0.93	2	2	2WU	0.93	18	9,821	9,821		6,580				121	
2021CPT.11.21.20862	Surry	62	SR 2215	Turner Mountain Rd	SR 2216	SR 1100	0.00	3.72	1	2	2WU	3.72	18			39,283	31,034				484	
2021CPT.11.21.20862	Surry	63	SR 2221	Rockford Rd	SR 2230	BR# 183/YADKIN CO LINE	10.18	11.05	1	2	2WU	0.87	18			9,187	7,258				113	
2021CPT.11.21.20862	Surry	64	SR 2236	Hardin Holyfield Rd	SR 2221	EOM	0.00	0.99	1	2	2WU	0.99	18			10,454	8,259				129	
2021CPT.11.21.20862	Surry	65	SR 2242	Fowler Cir	US 601 BUS	US 601 BUS	0.00	0.49	2	2	2WU	0.49	18	5,174	5,174		3,467				64	
2021CPT.11.21.20862	Surry	66	SR 2263	Circle Dr	US 601 BUS	EOM	0.00	0.41	2	2	2WU	0.41	18	4,330	4,330		2,901				53	
2021CPT.11.21.20862	Surry	67	SR 2219	Ridge Rd	US 601 BUS	EOM	0.00	0.44	2	2	2WU	0.44	18	4,646	4,646		3,113				57	
2021CPT.11.21.20862	Surry	68	SR 2276	Clay Davis Rd	SR 1100	EOM	0.00	0.23	2	2	2WU	0.23	16	2,159	2,159		1,446				30	
2021CPT.11.21.20862	Surry	69	SR 2403	Watershed Rd	SR 1396	EOM	0.00	0.39	2	2	2WU	0.39	20	4,576	4,576		3,066				51	
2021CPT.11.21.20862	Surry	70	SR 2420	Old E. Pine St	SR 1732	EOM	0.00	0.08	2	2	2WU	0.08	20	915	915		613				10	
<b>TOTAL FOR PROJECT NO. 2021CPT.11.21.20862</b>													<b>35.29</b>		<b>166,315</b>	<b>166,315</b>	<b>223,262</b>	<b>274,831</b>	<b>0</b>	<b>0</b>	<b>4,587</b>	<b>0</b>
2021CPT.11.21.20972	Wilkes	71	SR 2043	Martin Byrd Rd	SURRY CO LINE/SR 1158	SR 2037	0.00	0.62	1	2	2WU	0.62	18			6,547	5,172				81	
<b>TOTAL FOR PROJECT NO. 2021CPT.11.21.20972</b>													<b>0.62</b>		<b>0</b>	<b>0</b>	<b>6,547</b>	<b>5,172</b>	<b>0</b>	<b>0</b>	<b>81</b>	<b>0</b>
2021CPT.11.21.20992	Yadkin	72	SR 1311	Swaim St	SR 1396	SR 1386	1.04	1.28	1	2	2WU	0.24	20			2,816	2,225				31	
2021CPT.11.21.20992	Yadkin	73	SR 1343	Cranberry Rd	SR 1338	SR 1331	0.00	2.17	1	2	2WU	2.17	20			25,461	20,114				282	
2021CPT.11.21.20992	Yadkin	74	SR 1352	Fall Crk Ch Rd	NC 67	SR 1331	0.00	1.79	1	2	2WU	1.79	18			18,902	14,933				233	
2021CPT.11.21.20992	Yadkin	75	SR 1450	Pea Ridge Pass rd	EOM	WILKES CO	0.00	0.92	1	2	2WU	0.92	18			9,715	7,675				120	
2021CPT.11.21.20992	Yadkin	76	SR 1512	Reece Rd	NC 67	SR 1514	0.00	0.63	1	2	2WU	0.63	20			7,392	5,840				82	
2021CPT.11.21.20992	Yadkin	76A	SR 1512	Reece Rd	SR 1514	SR 1513	0.63	1.40	1	2	2WU	0.77	18			8,131	6,424				100	
2021CPT.11.21.20992	Yadkin	76B	SR 1513	Reece Rd	US 601	SR 1512	0.00	0.51	1	2	2WU	0.51	18			5,386	4,255				66	
2021CPT.11.21.20992	Yadkin	77	SR 1533	Holly Springs Rd	SR 1532	EOM	1.82	2.45	1	2	2WU	0.63	18			6,653	5,256				82	
2021CPT.11.21.20992	Yadkin	78	SR 1542	Mill Hill Rd	SR 1570	NC 67	0.00	2.03	1	2	2WU	2.03	20			23,819	18,817				264	
2021CPT.11.21.20992	Yadkin	79	SR 1542	Wooten Farm Rd	NC 67	SR 1541	2.04	2.36	1	2	2WU	0.32	20			3,755	2,966				42	
2021CPT.11.21.20992	Yadkin	80	SR 1548	Quaker Ave	SR 1545	NC 67	0.00	0.12	1	2	2WU	0.12	20			1,408	1,112				16	
2021CPT.11.21.20992	Yadkin	81	SR 1558	Hauser Rd	NC 67	SR 1559	0.00	0.53	1	2	2WU	0.53	18			5,597	4,421				69	
2021CPT.11.21.20992	Yadkin	82	SR 1559	Hauser Rd	SR 1558	SR 1560	0.19	0.83	1	2	2WU	0.64	18			6,758	5,339				83	
2021CPT.11.21.20992	Yadkin	83	SR 1726	Blevins Rd	SR 1725	DAVIE CO LINE	0.00	0.30	1	2	2WU	0.30	20			3,520	2,781				39	
<b>TOTAL FOR PROJECT NO. 2021CPT.11.21.20992</b>													<b>11.60</b>		<b>0</b>	<b>0</b>	<b>129,313</b>	<b>102,157</b>	<b>0</b>	<b>0</b>	<b>1,508</b>	<b>0</b>
<b>GRAND TOTAL</b>													<b>58.46</b>		<b>285,048</b>	<b>285,048</b>	<b>359,122</b>	<b>461,712</b>	<b>5</b>	<b>500</b>	<b>7,600</b>	<b>1</b>

8/17/99

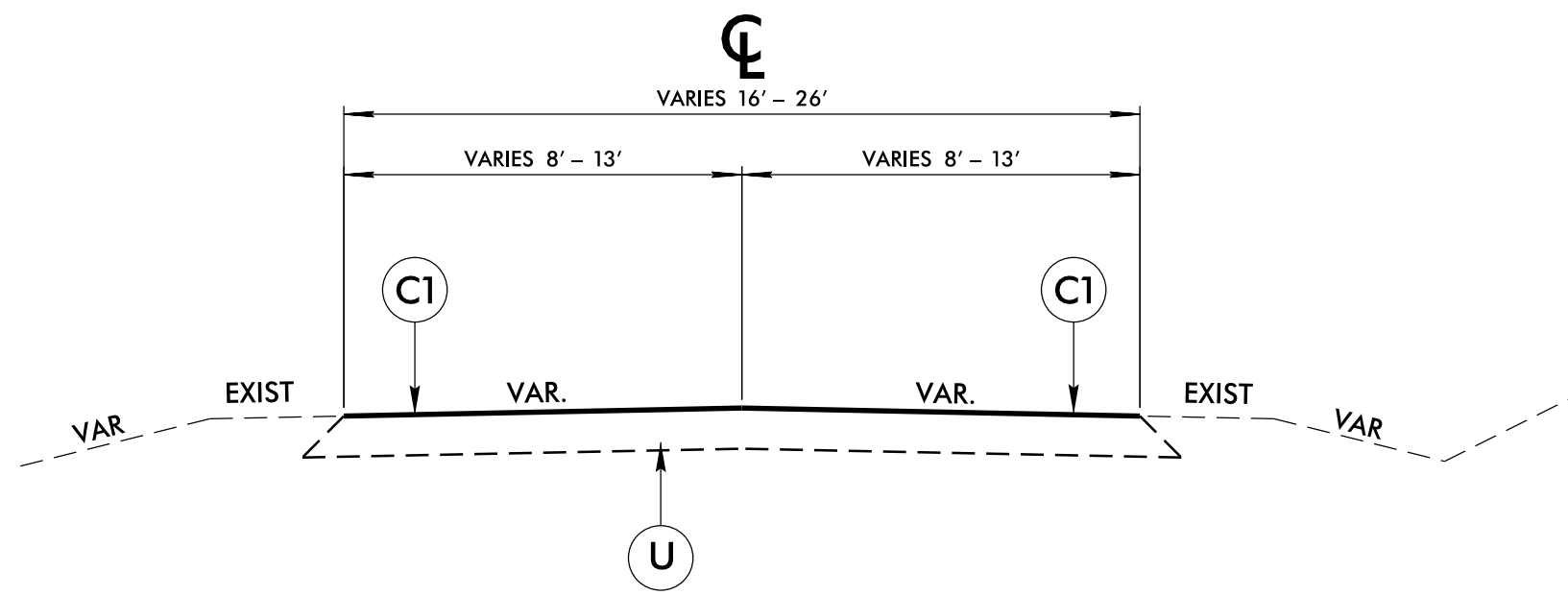

**TYPICAL SECTION NO. 1**

MAPS 11, 12, 13, 18, 31 - 35, 37, 55 - 57, 60, 62 - 64, 71 - 83

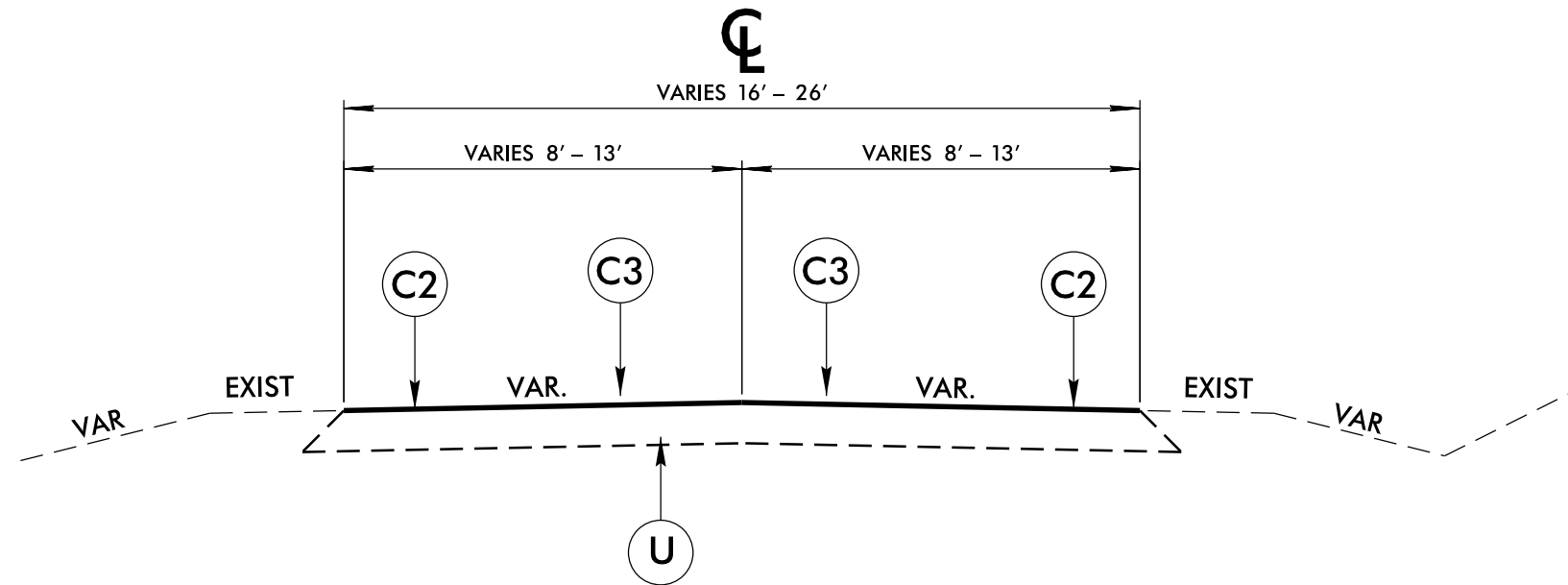

**TYPICAL SECTION NO. 2**

MAPS 1 - 10, 14 - 17, 19 - 30, 36, 38 - 54, 58, 59, 61, 65 - 70

PAVEMENT SCHEDULE	
C1	PROP. ASPHALT SURFACE TREATMENT, TRIPLE SEAL
C2	PROP. ASPHALT SURFACE TREATMENT, DOUBLE SEAL
C3	PROP. ASPHALT SURFACE TREATMENT, FOG SEAL
U	EXISTING PAVEMENT

DIVISION II DISTRICT 1 COUNTIES ASPHALT SURFACE TREATMENT RESURFACING		
DIVISION II		
REVISIONS	INT.	DATE
N.C. DEPARTMENT of TRANSPORTATION DIVISION of HIGHWAYS DIVISION ELEVEN		
SCALE: N/A	DATE: 02/25/202	
PREPARED BY: GK		
REVIEWED BY:		
REVIEWED BY:		

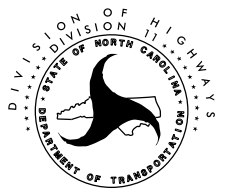



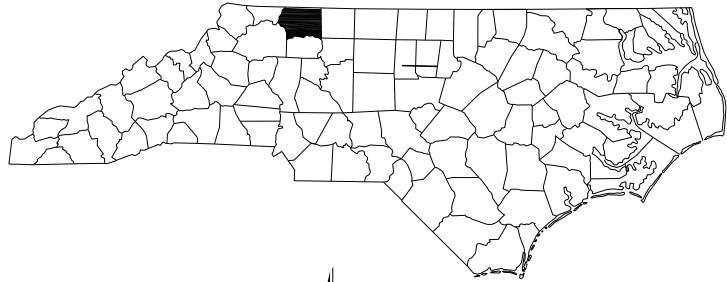

STATE OF NORTH CAROLINA  
DIVISION OF HIGHWAYS

**SURRY COUNTY**

TYPE OF WORK: AST - SECONDARY ROUTES

2021

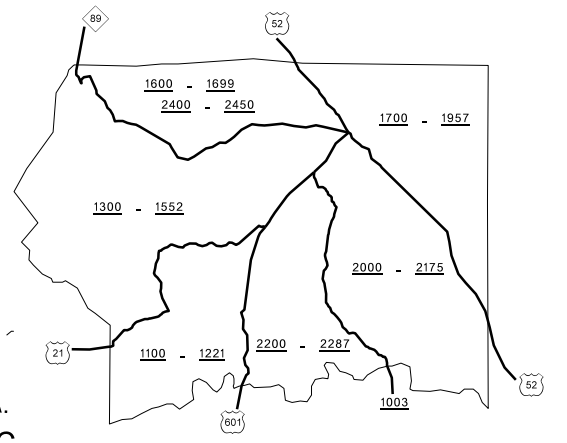

KEY TO COUNTY ROAD NUMBERS

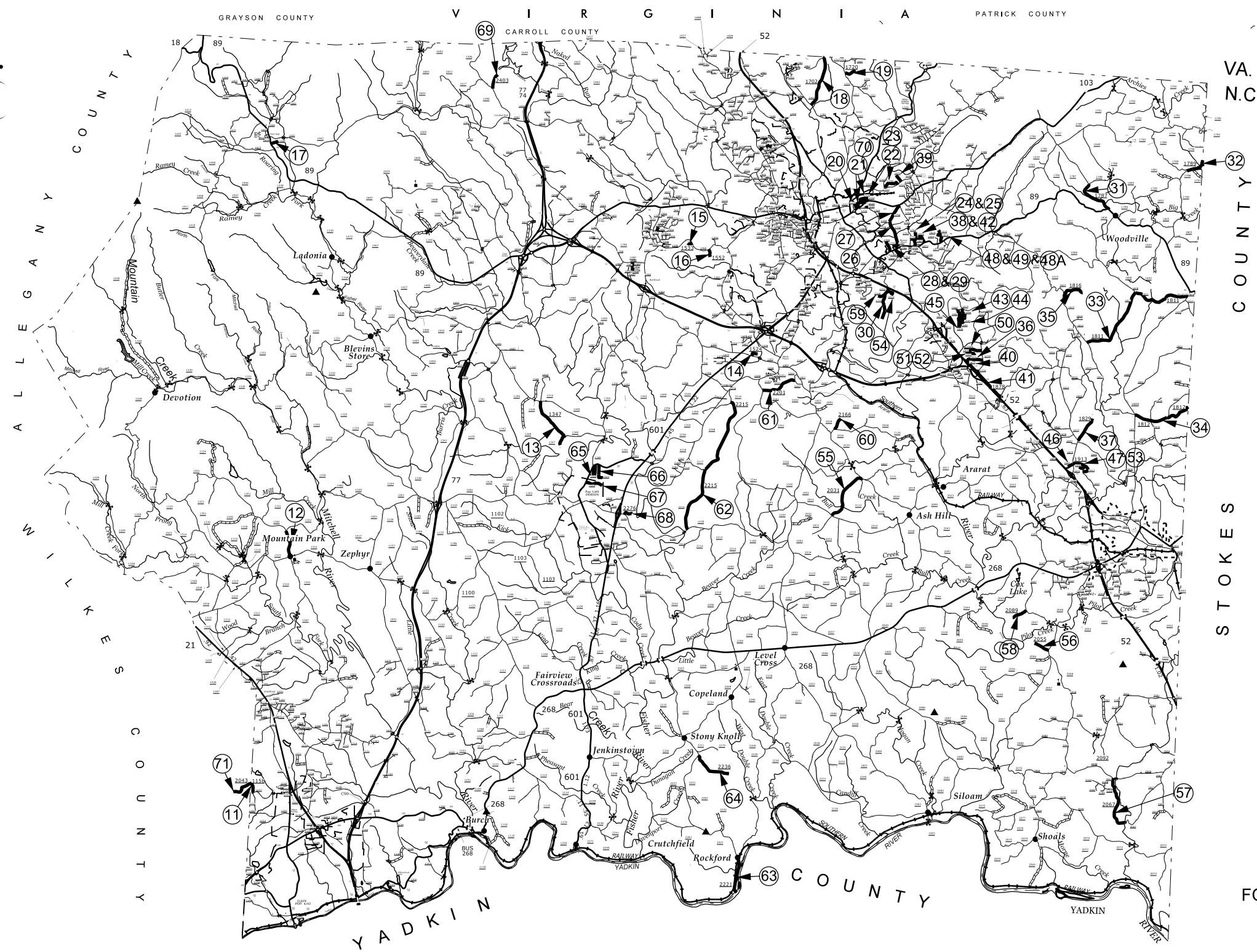

FORSYTH CO.



STATE OF NORTH CAROLINA  
DIVISION OF HIGHWAYS

**YADKIN COUNTY**

TYPE OF WORK: AST - SECONDARY ROUTES

2021

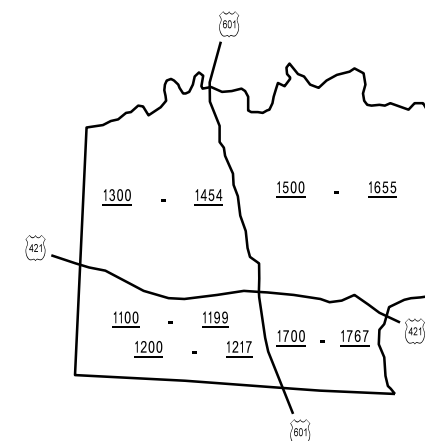
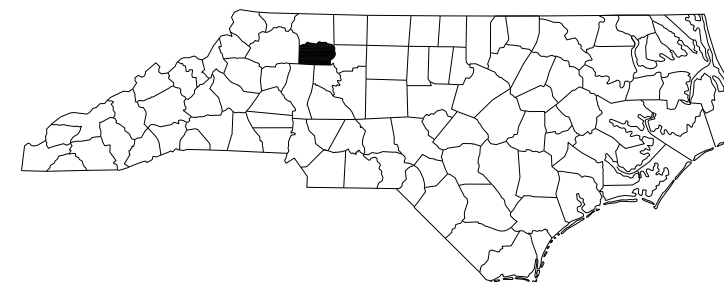
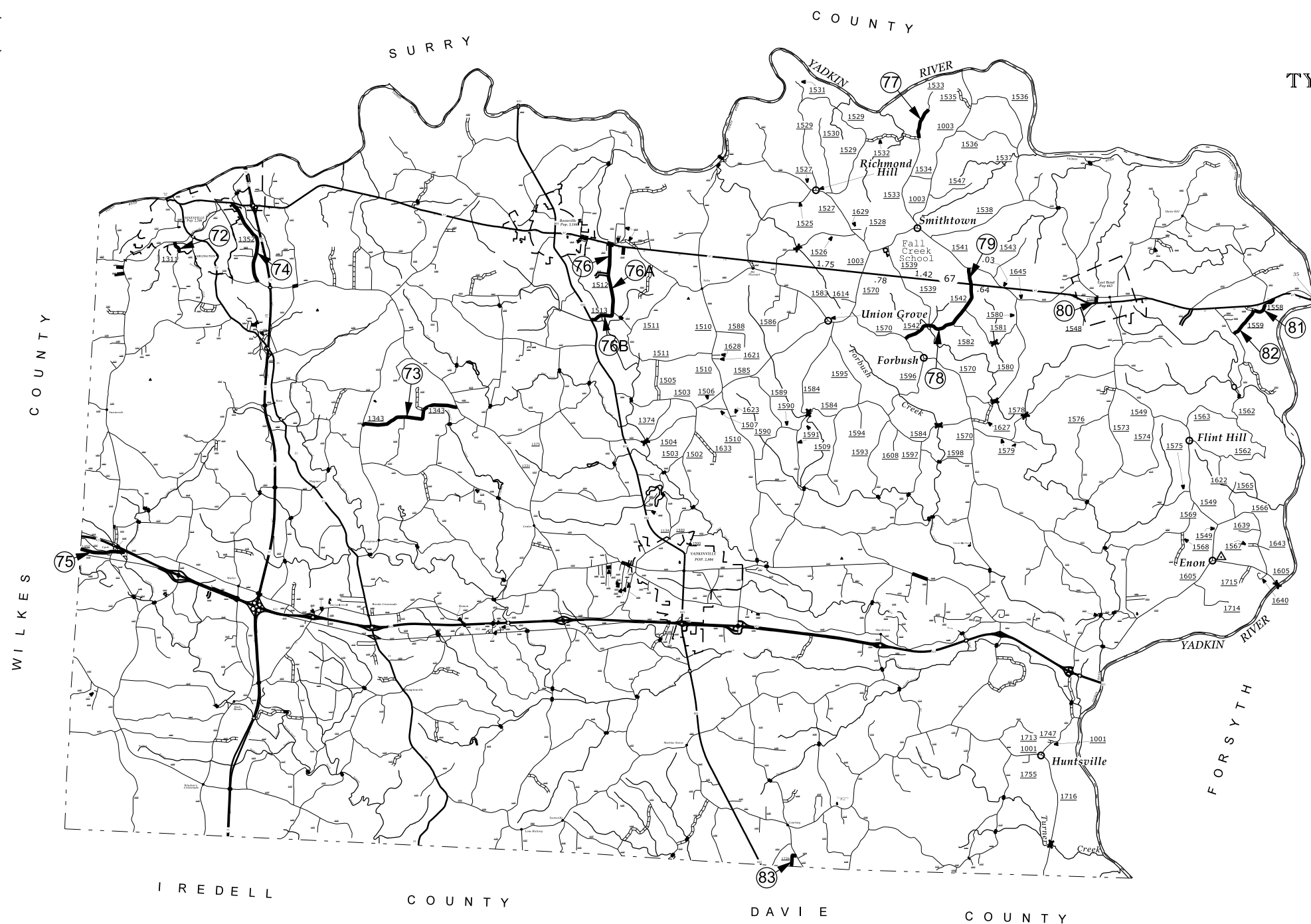

KEY TO COUNTY ROAD NUMBERS

# SIGNING FOR ASPHALT SURFACE TREATMENT

**LEGEND**

- ▷ PORTABLE SIGN
- └ STATIONARY SIGN
- ← DIRECTION OF TRAFFIC FLOW

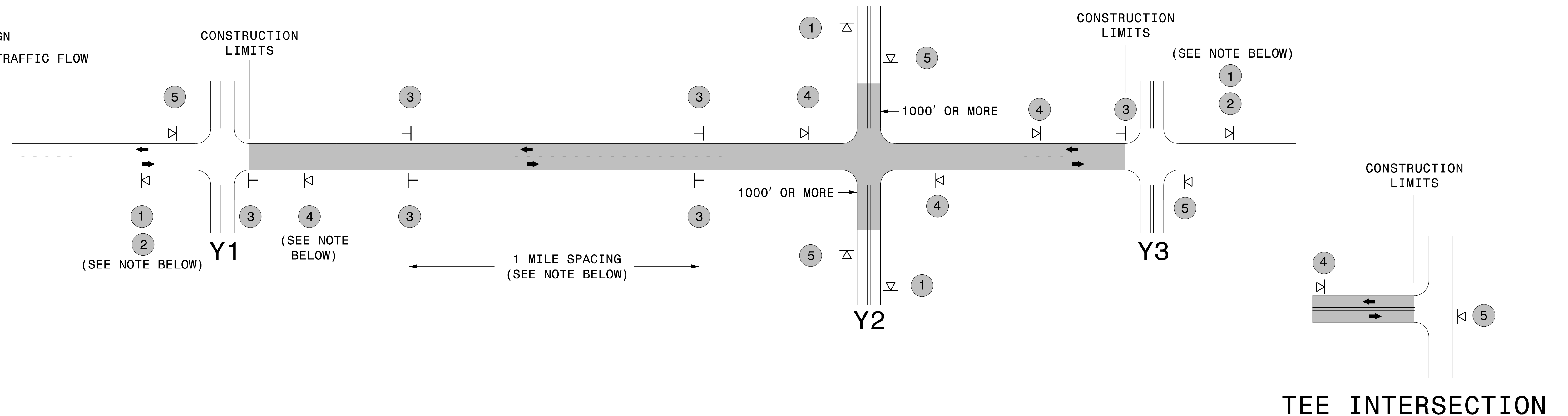

## MAINLINE (-L-) SIGNING

## -Y- LINE SIGNING

SIGNING NOTES AND PLACEMENT PER DIRECTION		<ul style="list-style-type: none"> <li>- PLACE 1000' PRIOR TO BEGINNING OF CONSTRUCTION LIMITS. ONLY USED ON -Y- LINES IF RESURFACING LIMITS EXTEND 1000' ALONG -Y- LINE.</li> <li>- SIGN #2 ONLY USED WHEN RESURFACING LIMITS ARE 2 OR MORE MILES IN LENGTH. ROUND UP TO THE NEAREST WHOLE NUMBER. DO NOT USE FRACTIONAL OR DECIMAL NUMBERS.</li> </ul>	<p><b>STATIONARY SIGNING NOT REQUIRED FOR THE FOLLOWING -Y- LINE CONDITIONS:</b></p> <ol style="list-style-type: none"> <li>1) LESS THAN 1000' OF RESURFACING ALONG -Y- LINE</li> <li>2) SUBDIVISION ROADS</li> <li>3) DEAD END ROADS</li> </ol> <p>WHEN PAVING/CONSTRUCTION ACTIVITIES PROCEED ACROSS AN UNSIGNED -Y- LINE, PORTABLE ADVANCE WARNING SIGNS SHALL BE USED ALONG THE -Y- LINE AS SHOWN BELOW. REMOVE UPON COMPLETION OF WORK.</p> <div style="display: flex; justify-content: space-around;"> <div style="text-align: center;"> <p>PLACED 500' IN ADVANCE OF FLAGGER.</p> </div> <div style="text-align: center;"> <p>PLACED 250' IN ADVANCE OF FLAGGER.</p> </div> </div>
		<ul style="list-style-type: none"> <li>- ALTERNATE THE FOLLOWING TWO SIGNS:</li> <li>- STARTING WITH "LOOSE GRAVEL" (W8-7) FOLLOWED BY "UNMARKED PAVEMENT".</li> <li>- PLACE INITIALLY AT THE CONSTRUCTION LIMITS AND SPACED 1 MILE APART THEREAFTER.</li> <li>- AT TEE INTERSECTIONS INSTALL INITIALLY 0.5 MILE FROM INTERSECTION AND SPACE 1 MILE APART THEREAFTER.</li> </ul>	
		<ul style="list-style-type: none"> <li>- THESE ARE FOR -Y- LINES THAT ARE "THROUGH" ROADWAYS. DEAD END AND SUBDIVISION ROADS ARE NOT "THROUGH" ROADWAYS.</li> <li>- INSTALL 500' +/- FROM EACH -Y- LINE APPROACH AS SHOWN ABOVE.</li> <li>- FOR MULTIPLE -Y- LINES THAT ARE SEPARATED BY 0.25 MILES OR LESS, TREAT AS A SINGLE UNIT AND INSTALL WITHIN 500' OF EACH APPROACH.</li> <li>- A MAXIMUM OF 2 SIGN SETS PER MILE. DO NOT INSTALL WHEN -Y- LINES ARE WITHIN 0.5 MILES FROM "END ROAD WORK" SIGN.</li> </ul>	
		<ul style="list-style-type: none"> <li>- PLACE 500' FOLLOWING THE END OF CONSTRUCTION LIMITS OR AS SHOWN WHEN WORK ENDS AT A 3-WAY TEE INTERSECTION.</li> </ul>	
	<p>THE ABOVE SIGNS ARE ALL THAT ARE REQUIRED FOR A CONTRACTOR TO BEGIN A RESURFACING CONTRACT. ANY ADDITIONAL SIGNS REQUESTED BY NCDOT DIVISIONS SHALL BE INSTALLED WITHIN 7 BUSINESS DAYS OF THE START OF CONTRACT WORK.</p>		

**MAPS LESS THAN 2 MILES**

FOR AST RESURFACING MAPS WITH CONSTRUCTION LIMITS LESS THAN 2 MILES IN LENGTH, USE A STATIONARY "LOOSE GRAVEL" SIGN AT THE BEGINNING CONSTRUCTION LIMIT FOLLOWED BY AN "UNMARKED PAVEMENT" SIGN MIDWAY THROUGH AND AN "END ROAD WORK" SIGN AT THE END CONSTRUCTION LIMIT.



**ADVANCE WARNING SIGNS FOR 2-LANE ROADWAY ASPHALT SURFACE TREATMENT**